

DRAWING ONLY

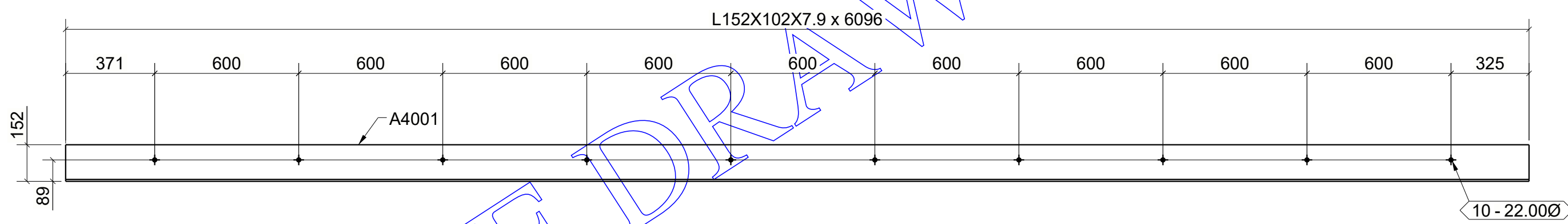

**ONE - ANGLE - A4001**

ASSEMBLY WEIGHT: 93lbs	ASSEMBLY AREA: 3.10m <sup>2</sup>	ASSEMBLY VOLUME: 0.01m <sup>3</sup>
---------------------------	--------------------------------------	--

BILL OF MATERIAL					
MARK	QTY	DESCRIPTION	LENGTH	WEIGHT	REMARKS
A4001	1	ANGLE			
A4001	1	L152X102X7.9	6096.00	206	300W
TOTAL WEIGHT THIS DRAWING				206	

**NOTE #1:** ARCHITECT, ENGINEER & G.C. PLEASE NOTE:  
IF NO COMMENTS APPEAR ON THIS DRAWING WHEN THE DRAWING ISSUED FOR APPROVAL / REVIEW, THEN ECOSSE WELDING WILL ASSUME THAT ITS INTERPRETATION OF ARCHITECTURAL AND STRUCTURAL DRAWINGS IS ACCEPTABLE BY ALL PARTIES, AND FABRICATION WILL PROCEED ACCORDINGLY.

REF:

MATERIAL: CAN3-G40.20 & G40.21  
HOLES: 22mm Ø (U.N.O)  
WELDS: 6mm Fillet (U.N.O)  
SURF PREP: SSPC-SP2  
PRIMER NOTE: ONE COAT SHOP PRIMER  
PAINT NOTE:  
REMARKS:

PROJECT:					
CUSTOMER:					
DETAIL: ANGLE				SHEET #:	REV:
DRAWN BY: RSK	CHECKED BY: MAK	JOB NUMBER: 7000	DWG NUMBER: A4001	0	
DATE:	PLOT DATE:				

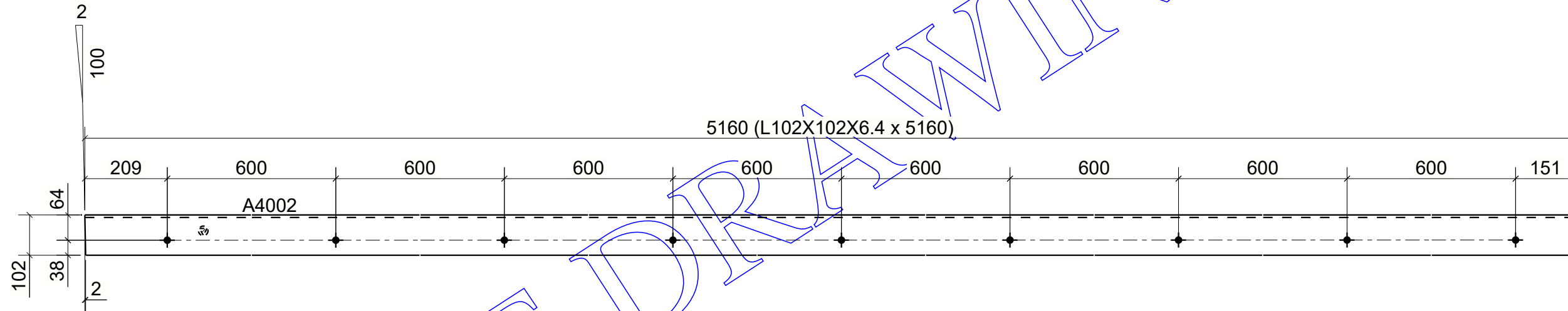

**ONE - ANGLE - A4002**

ASSEMBLY WEIGHT: 50lbs  
 ASSEMBLY AREA: 2.11m<sup>2</sup>  
 ASSEMBLY VOLUME: 0.01m<sup>3</sup>

**BILL OF MATERIAL**

MARK	QTY	DESCRIPTION	LENGTH	WEIGHT	REMARKS
A4002	1	ANGLE			
A4002	1	L102X102X6.4	5160.00	112	300W
TOTAL WEIGHT THIS DRAWING				112	

**NOTE #1:** ARCHITECT, ENGINEER & G.C. PLEASE NOTE:  
 IF NO COMMENTS APPEAR ON THIS DRAWING WHEN THE DRAWING ISSUED FOR APPROVAL / REVIEW, THEN ECOSSE WELDING  
 WILL ASSUME THAT ITS INTERPRETATION OF ARCHITECTURAL AND STRUCTURAL DRAWINGS IS ACCEPTABLE BY ALL PARTIES, AND FABRICATION WILL PROCEED ACCORDINGLY.

REF:  
 MATERIAL: CAN3-G40.20 & G40.21  
 HOLES: 22mm Ø (U.N.O)  
 WELDS: 6mm Fillet (U.N.O)  
 SURF PREP: SSPC-SP2  
 PRIMER NOTE: ONE COAT SHOP PRIMER  
 PAINT NOTE:  
 REMARKS:

<b>PROJECT:</b>			
<b>CUSTOMER:</b>			
<b>DETAIL: ANGLE</b>		<b>SHEET #:</b>	<b>REV:</b>
<b>DRAWN BY:</b> RSK	<b>CHECKED BY:</b> MAK	<b>JOB NUMBER:</b> 7000	<b>DWG NUMBER:</b> A4002
<b>DATE:</b>	<b>PLOT DATE:</b>		0

SAMPLED DRAWING ONLY

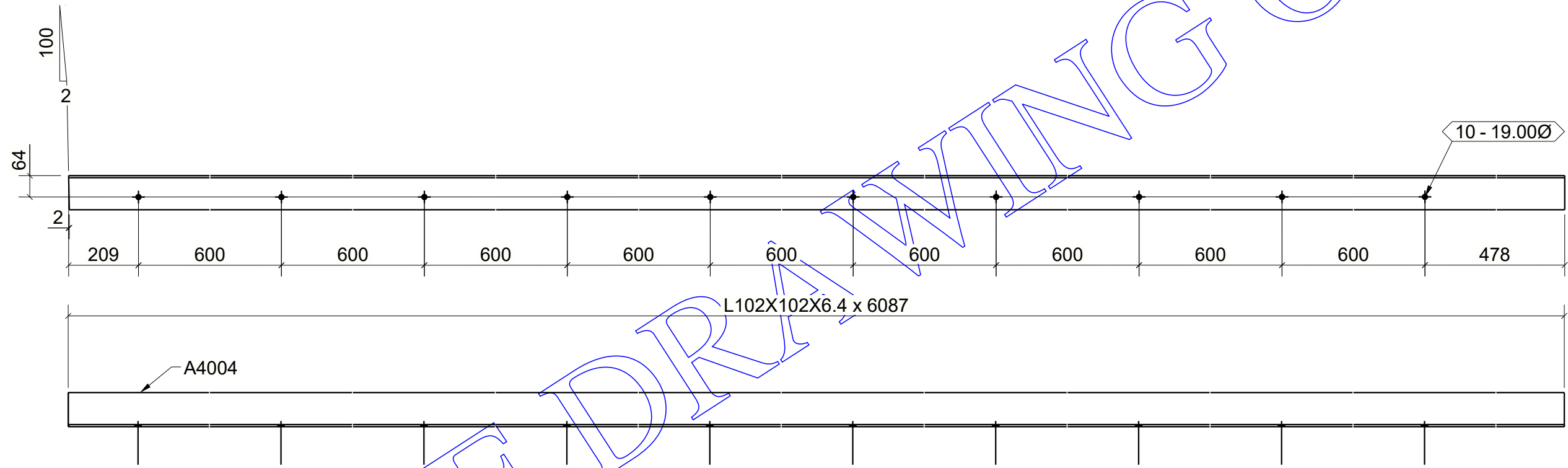

**ONE - ANGLE - A4004**

ASSEMBLY WEIGHT: 59lbs	ASSEMBLY AREA: 2.48m <sup>2</sup>	ASSEMBLY VOLUME: 0.01m <sup>3</sup>
---------------------------	--------------------------------------	--

BILL OF MATERIAL					
MARK	QTY	DESCRIPTION	LENGTH	WEIGHT	REMARKS
A4004	1	ANGLE			
A4004	1	L102X102X6.4	6087.00	132	300W
TOTAL WEIGHT THIS DRAWING				132	

**NOTE #1:** ARCHITECT, ENGINEER & G.C. PLEASE NOTE:  
 IF NO COMMENTS APPEAR ON THIS DRAWING WHEN THE DRAWING ISSUED FOR APPROVAL / REVIEW, THEN ECOSSE WELDING  
 WILL ASSUME THAT ITS INTERPRETATION OF ARCHITECTURAL AND STRUCTURAL DRAWINGS IS ACCEPTABLE BY ALL PARTIES, AND FABRICATION WILL PROCEED ACCORDINGLY.  
 REF:  
 MATERIAL: CAN3-G40.20 & G40.21  
 HOLES: 22mm Ø (U.N.O)  
 WELDS: 6mm Fillet (U.N.O)  
 SURF PREP: SSPC-SP2  
 PRIMER NOTE: ONE COAT SHOP PRIMER  
 PAINT NOTE:  
 REMARKS:

PROJECT:				
CUSTOMER:				
DETAIL: ANGLE			SHEET #:	REV:
DRAWN BY: RSK	CHECKED BY: MAK	JOB NUMBER: 7000	DWG NUMBER: A4004	0

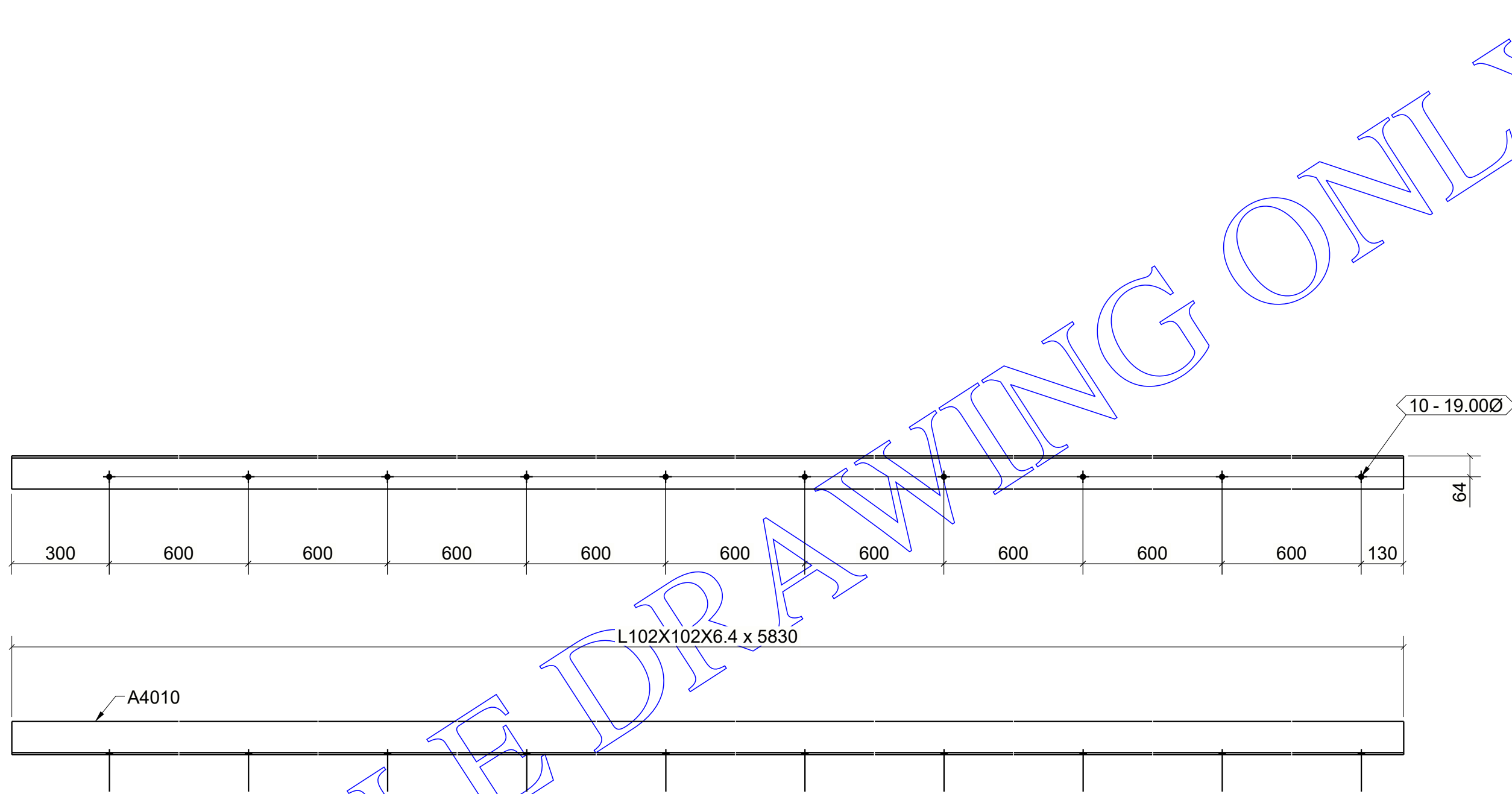

**ONE - ANGLE - A4010**

ASSEMBLY WEIGHT: 57lbs  
 ASSEMBLY AREA: 2.38m<sup>2</sup>  
 ASSEMBLY VOLUME: 0.01m<sup>3</sup>

BILL OF MATERIAL					
MARK	QTY	DESCRIPTION	LENGTH	WEIGHT	REMARKS
A4010	1	ANGLE			
A4010	1	L102X102X6.4	5830.00	127	300W
TOTAL WEIGHT THIS DRAWING				127	

**NOTE #1:** ARCHITECT, ENGINEER & G.C. PLEASE NOTE:  
 IF NO COMMENTS APPEAR ON THIS DRAWING WHEN THE DRAWING ISSUED FOR APPROVAL / REVIEW, THEN ECOSSE WELDING  
 WILL ASSUME THAT ITS INTERPRETATION OF ARCHITECTURAL AND STRUCTURAL DRAWINGS IS ACCEPTABLE BY ALL PARTIES, AND FABRICATION WILL PROCEED ACCORDINGLY.  
 REF:  
 MATERIAL: CAN3-G40.20 & G40.21  
 HOLES: 22mm Ø (U.N.O)  
 WELDS: 6mm Fillet (U.N.O)  
 SURF PREP: SSPC-SP2  
 PRIMER NOTE: ONE COAT SHOP PRIMER  
 PAINT NOTE:  
 REMARKS:

<b>PROJECT:</b>			
<b>CUSTOMER:</b>			
<b>DETAIL: ANGLE</b>		<b>SHEET #:</b>	
<b>DRAWN BY:</b> RSK	<b>CHECKED BY:</b> MAK	<b>JOB NUMBER:</b> 7000	<b>DWG NUMBER:</b> A4010
<b>DATE:</b>	<b>PLOT DATE:</b>		<b>REV:</b> 0

SAMPLED DRAFTING ONLY

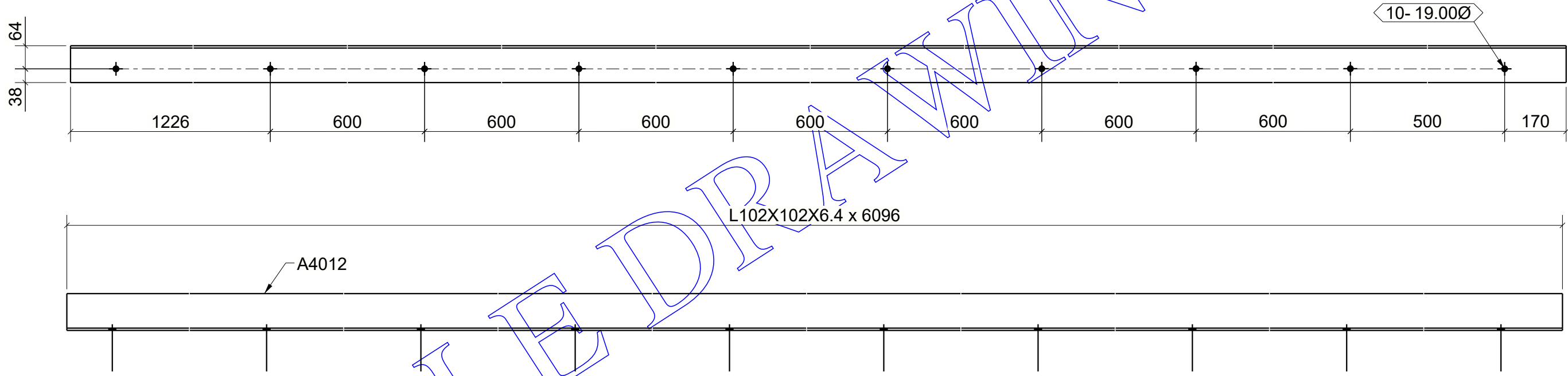

**ONE - ANGLE - A4012**

ASSEMBLY WEIGHT: 60lbs  
 ASSEMBLY AREA: 2.49m<sup>2</sup>  
 ASSEMBLY VOLUME: 0.01m<sup>3</sup>

**BILL OF MATERIAL**

MARK	QTY	DESCRIPTION	LENGTH	WEIGHT	REMARKS
A4012	1	ANGLE			
A4012	1	L102X102X6.4	6096.00	132	300W
TOTAL WEIGHT THIS DRAWING				132	

**NOTE #1:** ARCHITECT, ENGINEER & G.C. PLEASE NOTE:  
 IF NO COMMENTS APPEAR ON THIS DRAWING WHEN THE DRAWING ISSUED FOR APPROVAL / REVIEW, THEN ECOSSE WELDING  
 WILL ASSUME THAT ITS INTERPRETATION OF ARCHITECTURAL AND STRUCTURAL DRAWINGS IS ACCEPTABLE BY ALL PARTIES, AND FABRICATION WILL PROCEED ACCORDINGLY.  
 REF:  
 MATERIAL: CAN3-G40.20 & G40.21  
 HOLES: 22mm Ø (U.N.O)  
 WELDS: 6mm Fillet (U.N.O)  
 SURF PREP: SSPC-SP2  
 PRIMER NOTE: ONE COAT SHOP PRIMER  
 PAINT NOTE:  
 REMARKS:

<b>PROJECT:</b>			
<b>CUSTOMER:</b>			
<b>DETAIL: ANGLE</b>		<b>SHEET #:</b>	
<b>DRAWN BY:</b> RSK	<b>CHECKED BY:</b> MAK	<b>JOB NUMBER:</b> 7000	<b>DWG NUMBER:</b> A4012
<b>DATE:</b>	<b>PLOT DATE:</b>		<b>REV:</b> 0

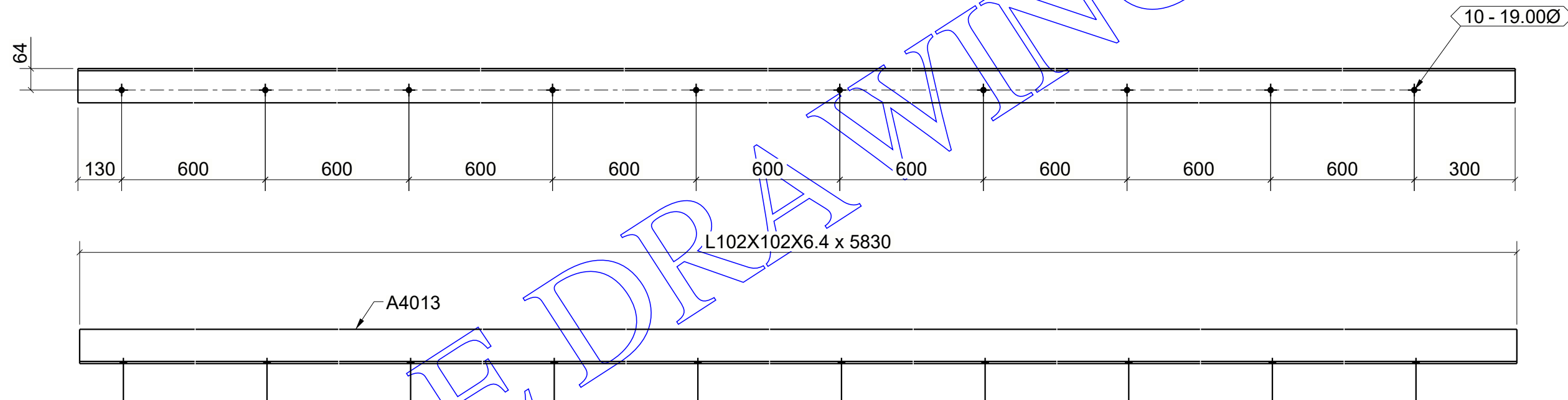

**ONE - ANGLE - A4013**

ASSEMBLY WEIGHT: 57lbs  
 ASSEMBLY AREA: 2.38m<sup>2</sup>  
 ASSEMBLY VOLUME: 0.01m<sup>3</sup>

**BILL OF MATERIAL**

MARK	QTY	DESCRIPTION	LENGTH	WEIGHT	REMARKS
A4013	1	ANGLE			
A4013	1	L102X102X6.4	5830.00	127	300W
TOTAL WEIGHT THIS DRAWING				127	

**NOTE #1:** ARCHITECT, ENGINEER & G.C. PLEASE NOTE:  
 IF NO COMMENTS APPEAR ON THIS DRAWING WHEN THE DRAWING ISSUED FOR APPROVAL / REVIEW, THEN ECOSSE WELDING WILL ASSUME THAT ITS INTERPRETATION OF ARCHITECTURAL AND STRUCTURAL DRAWINGS IS ACCEPTABLE BY ALL PARTIES, AND FABRICATION WILL PROCEED ACCORDINGLY.  
 REF:  
 MATERIAL: CAN3-G40.20 & G40.21  
 HOLES: 22mm Ø (U.N.O)  
 WELDS: 6mm Fillet (U.N.O)  
 SURF PREP: SSPC-SP2  
 PRIMER NOTE: ONE COAT SHOP PRIMER  
 PAINT NOTE:  
 REMARKS:

<b>PROJECT:</b>			
<b>CUSTOMER:</b>			
<b>DETAIL: ANGLE</b>			<b>SHEET #:</b>
<b>DRAWN BY:</b> RSK	<b>CHECKED BY:</b> MAK	<b>JOB NUMBER:</b> 7000	<b>DWG NUMBER:</b> A4013
<b>DATE:</b>	<b>PLOT DATE:</b>		<b>REV:</b> 0

DRAWING ONLY

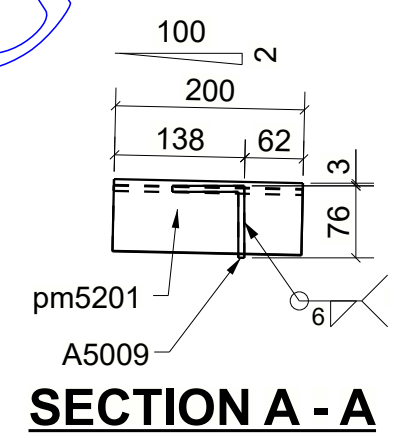
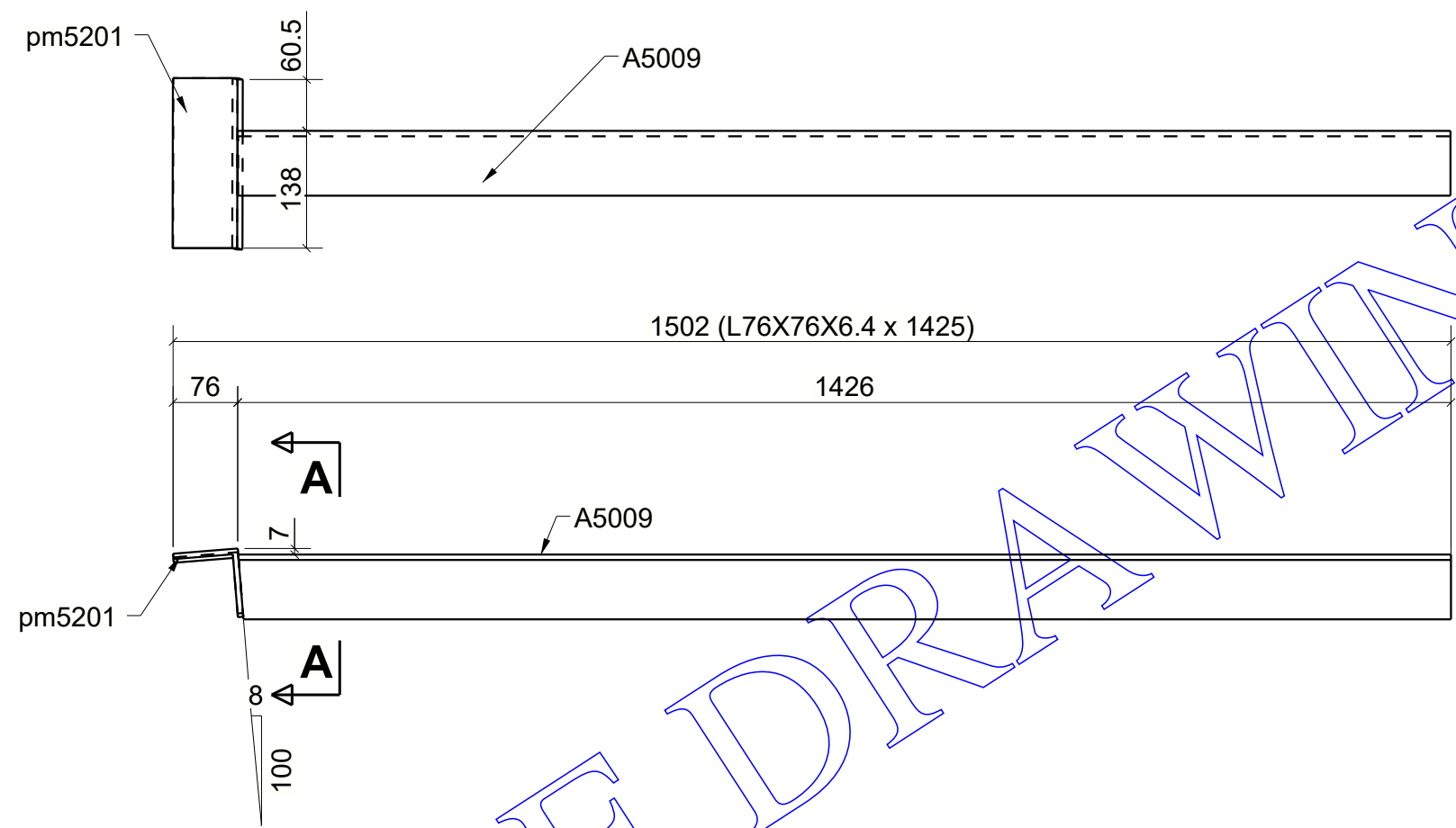

**2 - ANGLES - A5009**

ASSEMBLY WEIGHT: 11lbs	ASSEMBLY AREA: 0.50m <sup>2</sup>	ASSEMBLY VOLUME: 0.00m <sup>3</sup>
---------------------------	--------------------------------------	--

BILL OF MATERIAL					
MARK	QTY	DESCRIPTION	LENGTH	WEIGHT	REMARKS
A5009	2	ANGLES			
A5009	2	L76X76X6.4	1425.00	46	300W
pm5201	2	L76X76X6.4	200.00	6	300W
TOTAL WEIGHT THIS DRAWING				52	

**NOTE #1:** ARCHITECT, ENGINEER & G.C. PLEASE NOTE:  
 IF NO COMMENTS APPEAR ON THIS DRAWING WHEN THE DRAWING ISSUED FOR APPROVAL / REVIEW, THEN ECOSSE WELDING WILL ASSUME THAT ITS INTERPRETATION OF ARCHITECTURAL AND STRUCTURAL DRAWINGS IS ACCEPTABLE BY ALL PARTIES, AND FABRICATION WILL PROCEED ACCORDINGLY.

REF:  
 MATERIAL: CAN3-G40.20 & G40.21  
 HOLES: 22mm Ø (U.N.O)  
 WELDS: 6mm Fillet (U.N.O)  
 SURF PREP: SSPC-SP2  
 PRIMER NOTE: ONE COAT SHOP PRIMER  
 PAINT NOTE:  
 REMARKS:

<b>PROJECT:</b>				
<b>CUSTOMER:</b>				
<b>DETAIL: ANGLE</b>			<b>SHEET #:</b>	<b>REV:</b>
<b>DRAWN BY:</b> RSK	<b>CHECKED BY:</b> MAK	<b>JOB NUMBER:</b> 7000	<b>DWG NUMBER:</b> A5009	△ 0